

JVC



COMPACT COMPONENT SYSTEM

组合音响系统

VS-DT88V/VS-DT68V

Consists of CA-VSDT88V and SP-VSDT88V/Consists of CA-VSDT68V and SP-VSDT68V

由CA-VSDT88V及SP-VSDT88V构成/由CA-VSDT68V及SP-VSDT68V构成

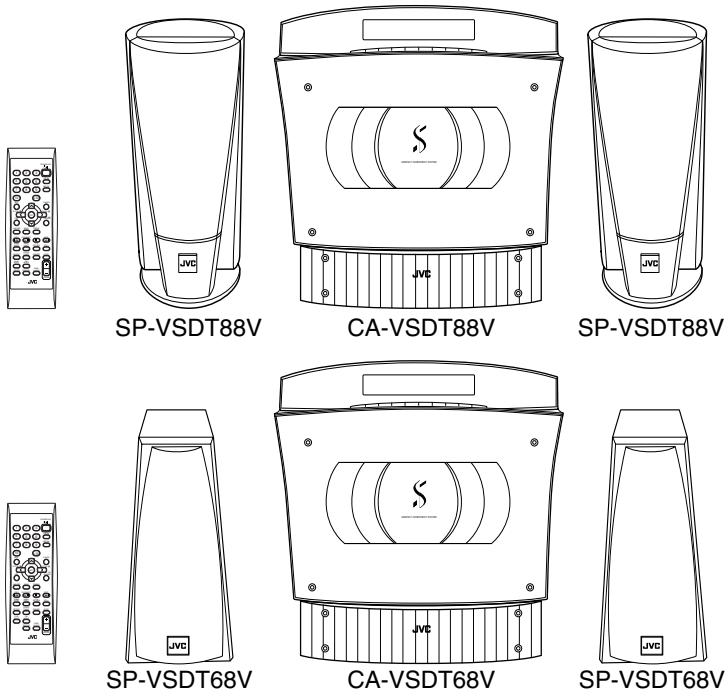

INSTRUCTIONS 使用说明书

For Customer Use:

Enter below the Model No. and Serial No. which are located either on the rear, bottom or side of the cabinet. Retain this information for future reference.

Model No. _____

Serial No. _____

GVT0085-003B

[US]

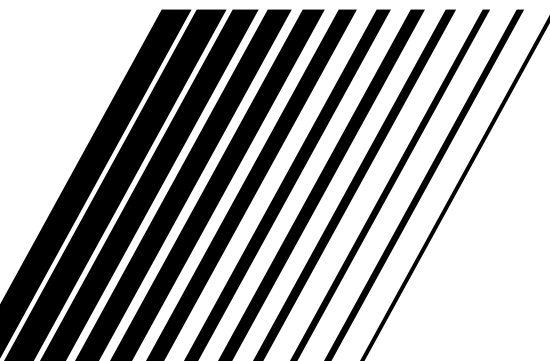

Warnings, Cautions and Others

警告，注意及其他须知事项

CAUTION

To reduce the risk of electrical shocks, fire, etc.:

1. Do not remove screws, covers or cabinet.
2. Do not expose this appliance to rain or moisture.

注意

为了防止触电，火灾等危险：

1. 请勿擅自卸下螺丝钉，盖子或机壳。
2. 切勿让本机受雨淋或置潮湿环境中。

Caution — ϕ /I switch!

Disconnect the mains plug to shut the power off completely (the ϕ /I goes off).

The ϕ /I switch in any position does not disconnect the mains line.

- When the unit is on standby, the ϕ /I lights red.
- When the unit is turned on, the operation lamps light red.

The power can be remote controlled.

注意 - ϕ /I 开关！

按下电源插头来完全切断电源（ ϕ /I 熄灭）。

ϕ /I 开关位于任何位置均未切断电源。

- 当本机处于待机状态时， ϕ /I 将点亮呈红色。
- 当本机打开时，操作指示灯将点亮呈红色。

电源可以遥控操作。

IMPORTANT FOR LASER PRODUCTS / 镭射产品的重要说明

REPRODUCTION OF LABELS / 标签内容说明

① CLASSIFICATION LABEL, PLACED ON EXTERIOR SURFACE

① 分类标签，贴在外表面。

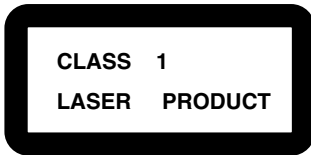

② WARNING LABEL, PLACED INSIDE THE UNIT

② 警告标签，贴于机内。

CAUTION: Invisible laser radiation when open and interlock failed or defeated. AVOID DIRECT EXPOSURE TO BEAM.	ADVARSEL: Usynlig laserstråling ved åbning, når sikkerhedsafbrydere er ude af funktion. Undgåudsæt- (e) telse for stråling.	WARNING: Osynlig laserstråling når denna del är öppnad och spårren är urkopplad. Beträkta ej (d) strålen.	VARO: Avattaessa ja suojalukitus ohitettaessa olet alttiina näkymättömälle lasersäteilylle. Älä katso säteeseen. (f)
--	--	--	---

1. CLASS 1 LASER PRODUCT
2. **CAUTION:** Invisible laser radiation when open and interlock failed or defeated. Avoid direct exposure to beam.
3. **CAUTION:** Do not open the top cover. There are no user serviceable parts inside the unit; leave all servicing to qualified service personnel.

1. 一级镭射产品。
2. **注意：**当内部锁定装置失效或损坏后，打开盖板可能会产生不可见的镭射辐射。应避免受到光束直接照射。
3. **注意：**请勿打开顶盖板。本机内部没有用户可自行维修的部件；所有维修工作应由有资格的人员完成。

Caution: Proper Ventilation

To avoid risk of electric shock and fire, and to prevent damage, locate the apparatus as follows:

1. Top: No obstructions and open spacing.
2. Sides/ Front/ Back: No obstructions should be placed in the areas shown by the dimensions below.
3. Bottom: Place on the level surface. Maintain an adequate air path for ventilation by placing on a stand with a height of 10 cm or more.

注意：正确通风

为避免发生触电和火灾的危险，及防止本机受损，请将本机如下放置：

1. 顶部：没有障碍物及地方开阔。
2. 侧面/前面/背面：在图中所示范围中，不应放置任何障碍物。
3. 底部：放置在水平面上。放置在一个高 10 厘米或以上的台面上，以保持足够的通风通道。

Front view

前面

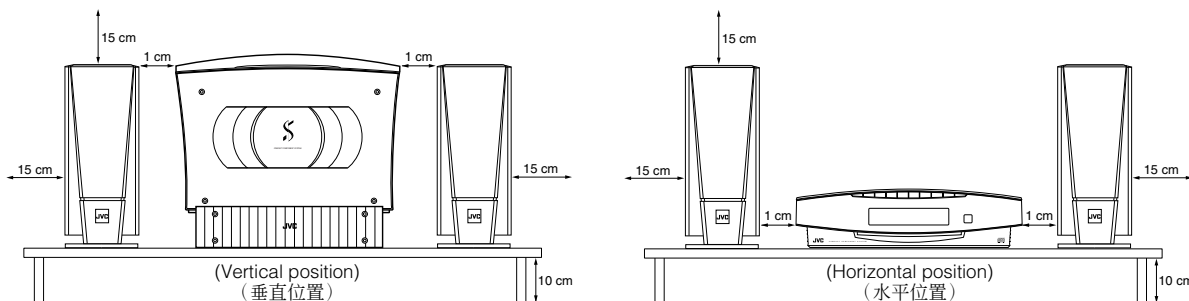
**CAUTION****■ About the Internal Cooling Fan**

This unit includes an internal cooling fan, so as to allow for high-power operation within a small space.

This fan comes on when the sound level is set high, and may also come on even at low sound levels if the internal temperature rises. To ensure effective fan operation, please leave at least 1 cm clearance on each side of the unit.

注意**■ 关于内部冷却风扇**

本机内含一台内部冷却风扇，使高功率的操作可以在一个细小空间内进行。当音量水平设定为高时风扇会启动，而即使音量水平不高但机内温度提升时，风扇也可能会启动。为确保风扇能有效操作，请在本机的每一侧留有至少 1 cm 的空间。

CAUTION

1. Do not block the ventilation openings or holes. (If the ventilation openings or holes are blocked by a newspaper or cloth, etc., the heat may not be able to get out.)
2. Do not place any naked flame sources, such as lighted candles, on the apparatus.
3. When discarding batteries, environmental problems must be considered and local rules or laws governing the disposal of these batteries must be followed strictly.
4. Do not expose this apparatus to rain, moisture, dripping or splashing and that no objects filled with liquids, such as vases, shall be placed on the apparatus.

注意

1. 请勿挡住通风口或孔。
(如通风口或孔被报纸或布料挡住，热力将不能排出。)
2. 请勿将任何明火源，例如点燃的蜡烛，放在本设备上。
3. 丢弃电池时，必须考虑环境问题并严格遵循当地有关丢弃此类电池的规定和法律。
4. 切勿将本装置暴露于雨水所及、潮湿、滴水或易于溅起水花的地方，亦不要将任何装满液体的物体（如花瓶）放置在本装置上。

Introduction

Thank you for purchasing the JVC Compact Component System.
We hope it will be a valued addition to your home, giving you years of enjoyment.
Be sure to read this instruction manual carefully before operating your new stereo system.
In it you will find all the information you need to set up and use the system.
If you have a query that is not answered by the manual, please contact your dealer.

Features

Here are some of the things that make your System both powerful and simple to use.

- With the slot-loading CD mechanism, you can choose to place the System either vertically or horizontally.
- Many types of compact discs are sold for a variety of uses. The Video CD Player can play the following compact discs.
Types of CD you can play:
 - **Video CD without Playback Control function:** for audio and video (moving picture) reproduction.
 - **Video CD with Playback Control function:** featuring menu-type operation and super-fine still pictures for audio and video (moving picture) reproduction.
 - **Digital Audio CD, finalized CD-R and CD-RW:** for audio reproduction. You can play back your original CD-R or CD-RW recorded in Music CD format or recorded in MP3 format that is compliant with ISO 9660 Level 1 or Level 2. (However they may not be played back depending on their characteristics or recording conditions.)
 - **CDs you cannot play:** Do not play SVCDs, DVDs, CD-ROMs, CD-G or CD-I Discs on this System. Playing CD-ROMs may generate a noise which can damage your speakers.
- The controls and operations have been redesigned to make them very easy to use, freeing you to just enjoy the music.
 - With JVC's **COMPU PLAY** you can turn on the System and automatically start the Radio or CD Player with a single touch.
- The System incorporates Active Hyper Bass PRO circuitry to faithfully reproduce low frequency sounds.
- A 45-station preset capability (30 FM and 15 AM) in addition to auto-seek and manual tuning.
- CD options that include repeat, random and program play.
- Timer functions; Daily Timer and Sleep Timer.
- You can connect various external units, such as an MD recorder.



How This Manual Is Organized

- Basic information that is the same for many different functions - e.g. setting the volume - is given in the section 'Basic Operations', and not repeated under each function.
- The names of buttons/controls and display messages are written in all capital letters: e.g. FM/AM, "CD NO DISC".
- System functions are written with an initial capital letter only: e.g. Normal Play.

Use the table of contents to look up specific information you require.

We have enjoyed making this manual for you, and hope it serves you in enjoying the many features built into your System.

WARNINGS

- **DO NOT PUT ANYTHING ON THE PANEL. IF THE SYSTEM IS OPERATED WITH SOMETHING PUT ON THE PANEL, IT WILL BE DAMAGED WHEN YOU TRY TO OPEN THE PANEL.**
- **SUPPLIED SPEAKERS ARE EXCLUSIVELY FOR THIS SYSTEM. USING WITH OTHER DEVICES WILL DAMAGE THE SPEAKERS.**

IMPORTANT CAUTIONS

1 Installation of the System

- Select a place which is level, dry and neither too hot nor too cold. (Between 5°C and 35°C.)
- Leave sufficient distance between the System and a TV.
- Do not use the System in a place subject to vibrations.

2 Power cord

- Do not handle the power cord with wet hands!
- Some power is always consumed as long as the power cord is connected to the wall outlet.
- When unplugging the System from the wall outlet, always pull the plug, not the power cord.

3 Malfunctions, etc.

- There are no user serviceable parts inside. In case of system failure, unplug the power cord and consult your dealer.
- Do not insert any metallic object into the System.
- Do not insert your hand between the Panel and the main body when the Panel is being closed.

Table of Contents

Getting Started	3
Accessories	3
Set the VOLTAGE SELECTOR Switch	3
How to put Batteries in the Remote Control	3
Connecting the FM Antenna	4
Connecting the AM Antenna	5
Connecting the Speakers	6
Connecting a Subwoofer	7
Connecting a TV	7
Connecting External Equipment	7
Connecting an MD Recorder, etc (Digital Output)	8
Connecting the AC Power Cord	8
Installing the Unit on the Stand	8
Installing the Equipment on the Wall	9
Changing the Display and Control Buttons Settings	10
Using the Remote Control	11
COMPU Play	11
Basic Operations	12
Turning the Power On and Off	12
Adjusting the Brightness (DIMMER)	12
Changing the Color (COLOR) (VS-DT88V only)	13
Adjusting the Volume	13
Reinforcing the Bass Sound (AHB PRO)	14
Tone Control (BASS/TREBLE)	14
Showing the Time (DISPLAY)	14
Using the Tuner	15
Tuning In a Station	15
Presetting Stations	16
To Change the FM Reception Mode	16
Using the CD Player	17
MP3 Introduction	17
To Insert a CD	19
To Unload a CD	19
Basics of Using the CD Player — Normal Play	19
Programming the Playing Order of the Tracks	20
Random Play	21
Repeating Tracks	21
Child Lock	21
Using the Video CD Player (Video CDs)	22
Setting the TV System	22
Selecting the Audio Channel	22
Playing Video CDs with PBC Function	23
Playing Video CDs with PBC Function without Using the Menu Screen (PBC OFF)	24
Playing Video CDs without the PBC Function	24
Various Functions to Enhance Your Enjoyment	25
Using External Equipment	26
Listening to External Equipment	26
Recording the System's Source to External Equipment	26
Using the Timers	27
Setting the Clock	27
Setting the Daily Timer	28
Setting the Sleep Timer	29
Care and Maintenance	30
Troubleshooting	31
Specifications	32

Getting Started

Accessories

Make sure that you have all of the following items, which are supplied with the System.

- Power Cord (1)
- AM Loop Antenna (1)
- Remote Control (1)
- Batteries (2)
- FM Wire Antenna (1)
- Speaker Cords (2)
- Video Cord (1)
- Stand (1) (for Center Unit)
- Legs (2) (for Stand)
- Screw (1) (for Stand)
- Paper Pattern (1)
- AC Plug Adaptor (1)

If any of these items are missing, contact your dealer immediately.

Set the VOLTAGE SELECTOR Switch

To avoid damaging the System, set the voltage before plugging in the System.

Set the correct voltage for your area with the VOLTAGE SELECTOR switch on the back of the Unit. By using a screwdriver, slide the VOLTAGE SELECTOR switch so that it corresponds to the voltage of your area.

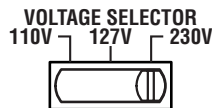

How to put Batteries in the Remote Control

Match the polarity (+ and -) on the batteries with the + and - markings in the battery compartment.

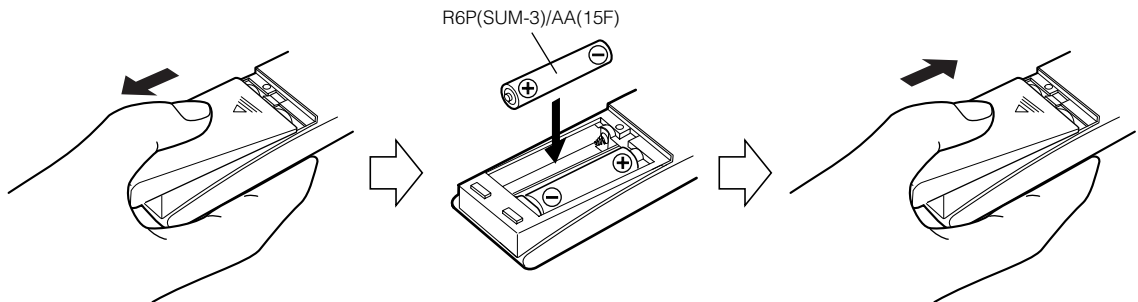

CAUTION:

• Handle batteries properly.

■ To avoid battery leakage or explosion:

- Remove batteries when the Remote Control will not be used for a long time.
- When you need to replace the batteries, replace both batteries at the same time with new ones.
- Do not use an old battery with a new one.
- Do not use different types of batteries together.

⚠ CAUTION:

- Make all connections before plugging the System into an AC power outlet.

Note**(Only if you install the Center Unit vertically)**

- To place the Center Unit **vertically**, the Stand and Legs must be attached. (See page 8.) To make connections, let the cords pass in the holes of the Stand as shown in the diagram before attaching the Stand and Legs.

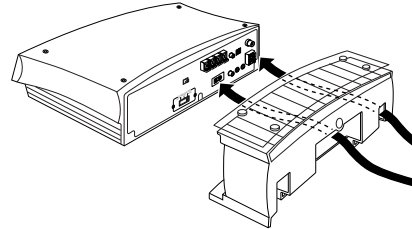
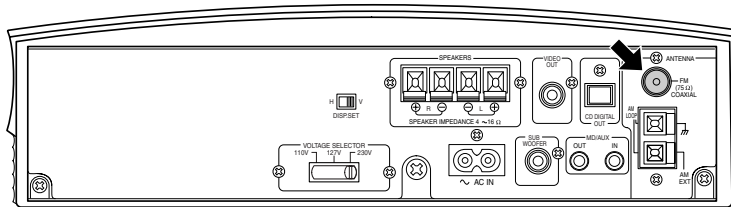
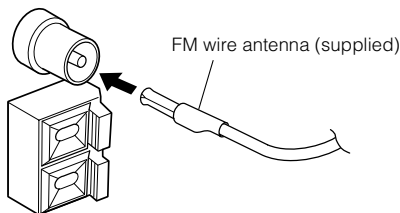
**Connecting the FM Antenna****Rear Panel of the Center Unit****Using the Supplied Wire Antenna**

If reception is poor, connect the outdoor antenna.

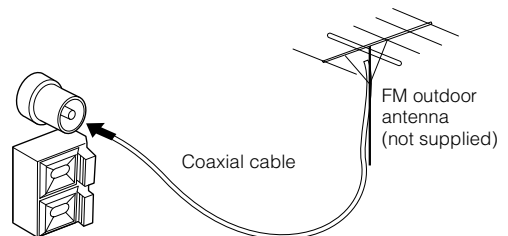
**Using the Coaxial Type Connector (Not Supplied)**

A 75 Ω antenna with coaxial type connector (IEC or DIN45 325) should be connected to the FM 75 Ω COAXIAL terminal.

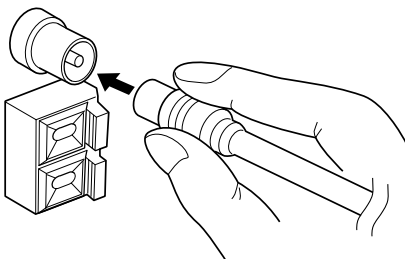
**Note**

- Before attaching a 75 Ω coaxial lead (the kind with a round wire going to an outdoor antenna), disconnect the supplied FM Wire Antenna.

Getting Started

Connecting the AM Antenna

Rear Panel of the Center Unit

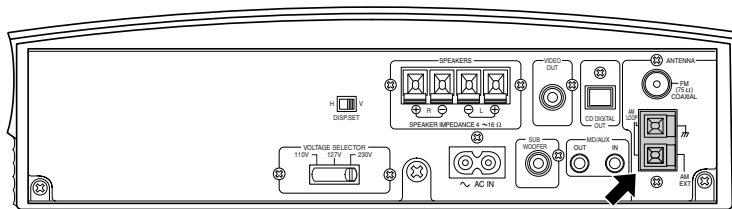

AM loop antenna (supplied)

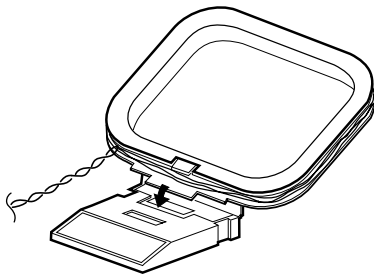

Attach the AM loop to its base by snapping the tabs on the loop into the slot in the base.

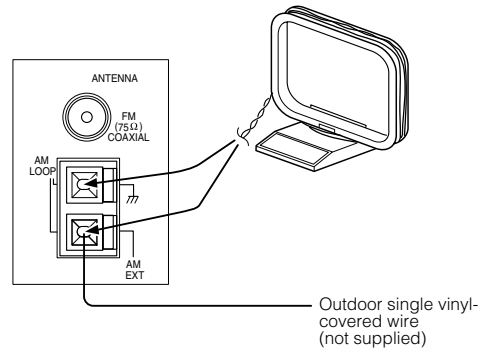

Turn the loop until you have the best reception.

- The AM loop antenna can be attached to a wall.

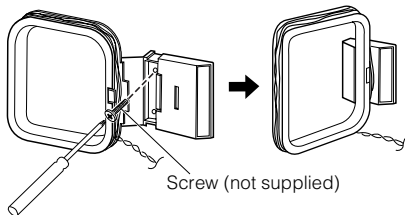

Screw (not supplied)

Notes

- If the AM loop antenna wire is covered with vinyl, remove the vinyl by twisting it as shown in the diagram.
- Make sure the antenna conductors do not touch any other terminals, connecting cords and power cord. This could cause poor reception.
- If reception is poor, connect an outdoor single vinyl-covered wire to the AM EXT terminal. (Keep the AM loop antenna connected.)

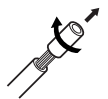

CAUTIONS:

- Make all connections before plugging the System into an AC power outlet.
- Handling the speakers
As this is a precision instrument, handle it carefully so as to protect it from shocks.

Connecting the Speakers

These speakers are exclusively for this system. Using with other devices will damage the speakers.

1. Open each of the terminals to connect the speaker wire leads.
2. Connect the speaker cords between the Speaker terminals of the Unit and the terminals of the Speakers.
Connect the cords with a black line to the (-) terminals and cords without a black line to the (+) terminals.
3. Close each of the terminals to securely connect the cords.

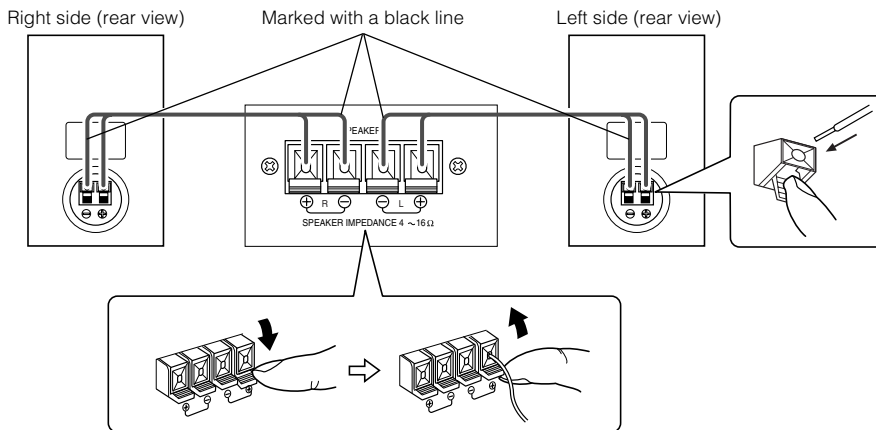
**Notes**

- Since both speakers are the same, you can put either one to the right or left side.
- Do not connect other speakers to the Unit. The difference of the load impedance causes failures.
- Do not use the supplied speakers in parallel with other speakers.

CAUTION:

- Although the speakers have internal magnetic shieldings, a TV may display irregular colors if located near the speakers. If this happens, set the speakers away from the TV.

Removing the speaker grilles

The speaker grilles can be removed.

When removing:

1. Pull the bottom towards you with your fingers.
2. Also pull the top towards you.

When attaching the speaker grilles:

Attach the speaker grilles as shown in the diagram.

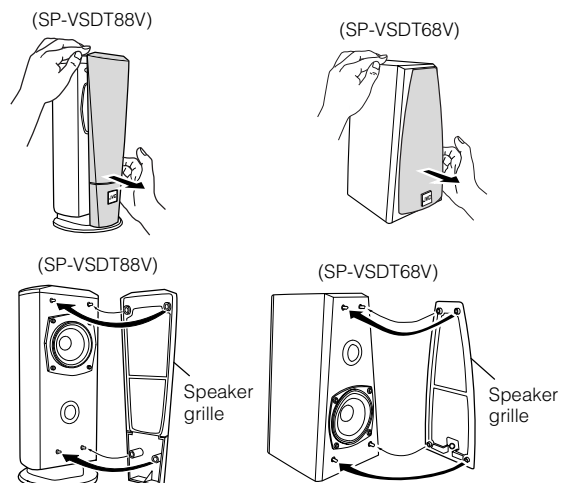

Getting Started

Connecting a Subwoofer

Connect a signal cord (not supplied) between the System's SUBWOOFER terminal and the input terminal of an external subwoofer.

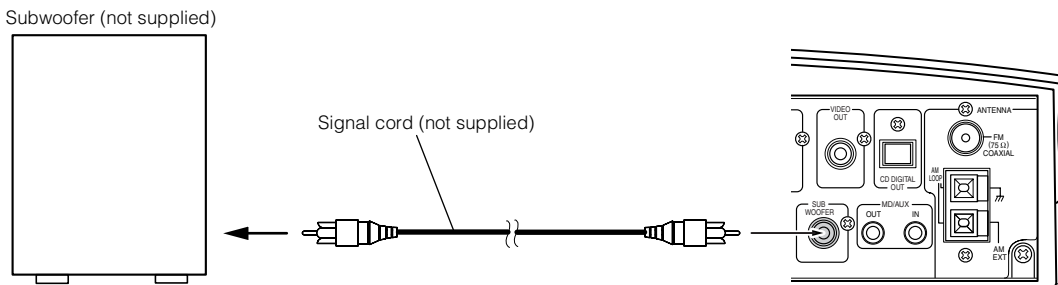

Connecting a TV

Connect a video cord (supplied) between the System's VIDEO OUT terminal and the video input jack of your TV.



- Do not connect a cable between the MD/AUX-OUT terminal and the audio input terminal of an external TV. If it is connected, noise may be generated depending on the TV to be used.

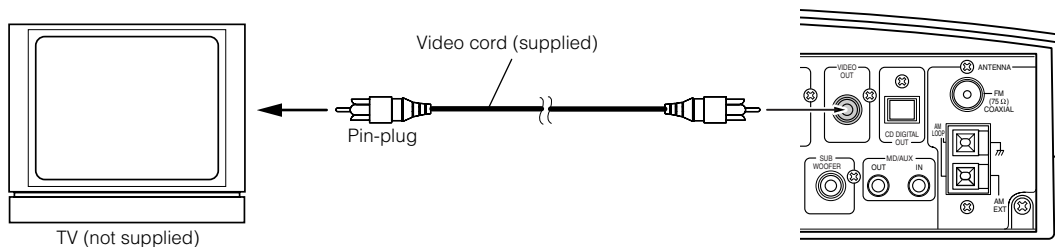

Connecting External Equipment

Connect signal cords (not supplied) between the System's MD/AUX-OUT/IN terminals and the output/input terminals of the external MD recorder, tape deck, etc.

You can then listen to the external source through the System or record the System's CD player or tuner to the external unit.

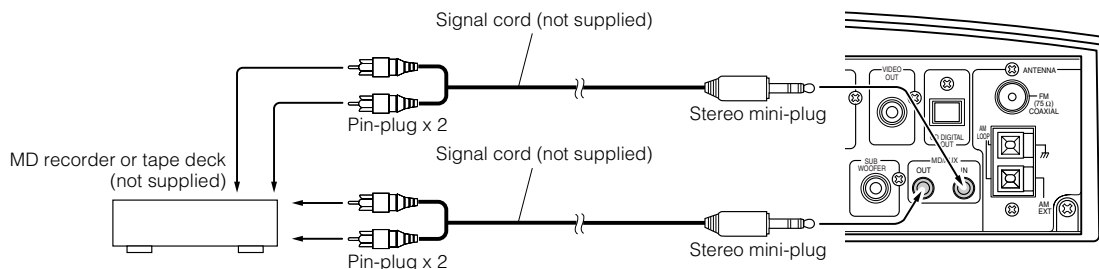

Connecting an MD Recorder, etc (Digital Output)

Remove the cap and connect an optical digital cord (not supplied) between the System's CD DIGITAL OUT terminal and the input terminal of the MD recorder, etc.

You can record the digital output signal from the System's CD Player to the MD recorder, etc.

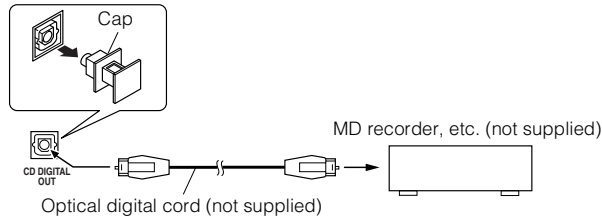

Connecting the AC Power Cord

Firmly insert the supplied AC power cord into the ~ AC IN terminal on the back of the Unit.

CAUTIONS:

- ONLY USE THE JVC POWER CORD PROVIDED WITH THIS SYSTEM TO AVOID MALFUNCTION OR DAMAGE TO THE SYSTEM.
- BE SURE TO UNPLUG THE POWER CORD FROM THE OUTLET WHEN GOING OUT OR WHEN THE SYSTEM IS NOT IN USE FOR AN EXTENDED PERIOD OF TIME.

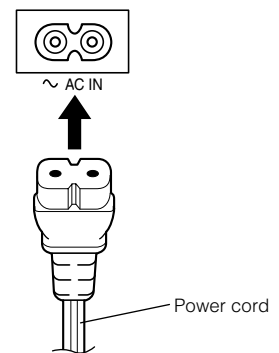

Installing the Unit on the Stand

You can place the Unit **vertically** by attaching the supplied Stand.

Attach the Stand to the Unit and tighten the screw.

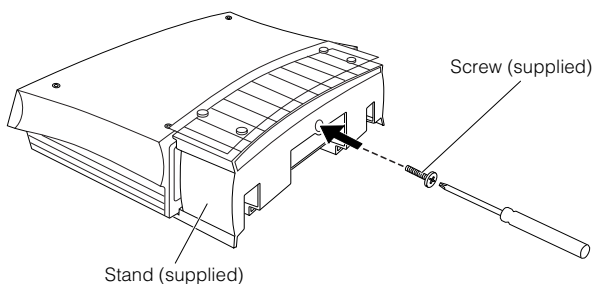

Attach the Legs to the Stand.

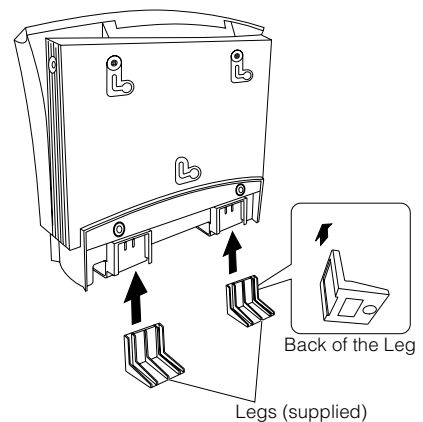

Note

- Avoid an unstable place when placing the Unit vertically. Select a place on the level surface.

Getting Started

Installing the Equipment on the Wall

The Center Unit and Speakers can be attached to a wall.

CAUTIONS:

Attachment to a wall

- The Center Unit weighs approximately 4.3 kg. When its buttons are operated, an additional force will be applied to it in the downward direction. Therefore, sufficient care must be taken when attaching to a wall to prevent any accidents caused by the Center Unit's falling off the wall.
- Before attaching the Center Unit to the wall, check the wall and other related aspects, and verify whether the strength of the wall will be sufficient not only to support the weight of the Center Unit itself but also to withstand the additional downward force which will be applied to it during operation. (Do not attach the Center Unit to a plywood or plasterboard wall. The Center Unit may fall and sustain damage as a result.) If you do not know the strength of the wall and other aspects, consult a qualified service person (such as a qualified constructor).
- The screws needed for attachment are not supplied. Use screws which are compatible with the strength and material of the pillar or wall.
- When attaching the Center Unit, the screws must be secured tightly in all three locations. Attaching the Center Unit to the wall by making only one or two holes for the screws makes for an unstable attachment and causes a safety hazard as the Center Unit may fall down.

Location of attachment to a wall

- Care is required in selecting a location for attaching the Center Unit to the wall. Injury to personnel, or damage to the Center Unit, may result if the Center Unit is attached in a location which interferes with daily activities or a location that the users are liable to knock their bodies or heads against.
- Avoid a location above a bed, sofa, water tank, sink, etc. or in a passage.

Example of attachment (Center Unit)

The procedure below is intended merely to illustrate how the Center Unit can be attached to a wall and does not make any guarantees for safety while using the Center Unit on a wall. Take into account such factors as the material and strength of the wall, the status of the reinforcing material, and the possible changes that will take place over time.

- The cords must be connected to the Center Unit before attaching to a wall. (See page 4.)
1. Select the place where the Center Unit is to be attached.
 2. Mount three screws (not supplied) on the wall. (See the diagram below for the details of the size.)
 - The supplied paper pattern will assist in determining the positions of the screws.

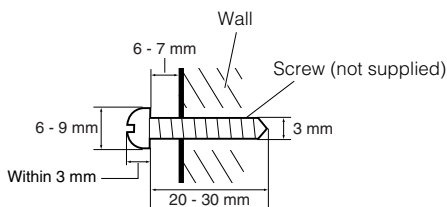

3. Hook the Center Unit onto the attached screws.
4. Slide the Center Unit to the side, and secure it.
 - Adjust the screws if the Center Unit is not attached firmly.

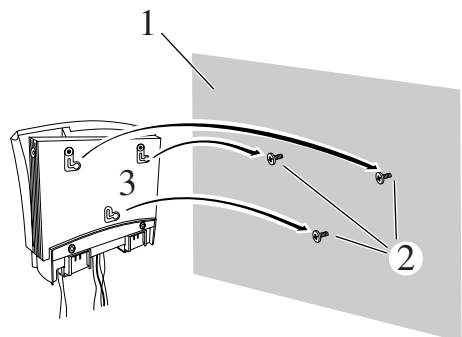

Slide to left, then down.

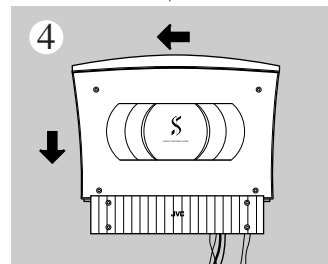

Example of attachment (Speakers) (SP-VSDT68V only)

The speakers can be attached to a wall.
Attach a screw (not supplied) on the wall, then hook the speaker onto the screw.

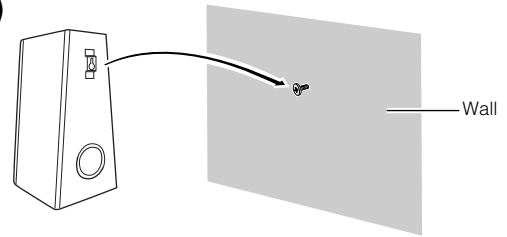

Notes

- Do not place anything on top of the Center Unit. Doing so may cause the Center Unit to fall, causing malfunctioning and/or injury.
- Do not climb onto the Center Unit or hang from it. Doing so may damage the Center Unit and/or cause injury. Special care must be taken in this respect when there are small children in the home.
- Avoid sandwiching the cords between the Center Unit and wall. This may upset the Center Unit's balance, causing the Center Unit to fall.
- Make sure that the cords will not interfere with daily activities and that the users will not trip over them. Do not pull the connected cords with excessive force.
- Check regularly that none of the screws are loose.
- In the event that the Center Unit has fallen, turn off the power, disconnect its power plug from the power outlet, and contact your dealer for an inspection and repairs. Continued use of the Center Unit may result in a fire or electric shocks.
- Do not place valuables (breakables) underneath the location where the Center Unit is attached. They will be damaged if the Center Unit should fall.
- The manufacturer accepts absolutely no liability for any accidents or damage resulting from inadequate assembly or mounting, insufficient strength of attachment, misuse or abuse, or natural disasters.

Now you can plug the AC power cord into the wall outlet, and your System is at your command!

Before operating, verify that the display shows the clock. If malfunctions may occur, re-connect the power cord.

Changing the Display and Control Buttons Settings

You can change the direction of the characters and symbols on the display and the assignment of the functions to each control button on the Unit. Change the settings depending on whether the Unit is placed vertically or horizontally. The factory setting is "V".

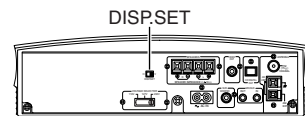

When the Unit is placed vertically

Set the DISP.SET switch to "V".

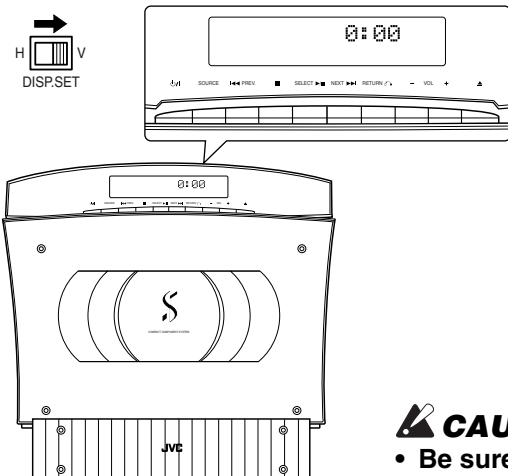

When the Unit is placed horizontally

Set the DISP.SET switch to "H".

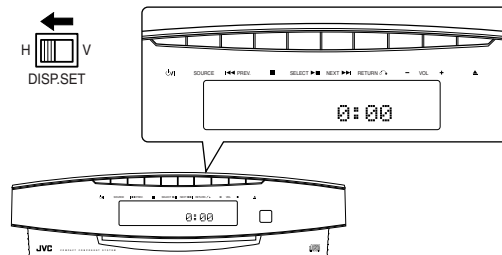

CAUTION:

- Be sure to turn off the System when changing the settings.

Getting Started

Using the Remote Control

The Remote Control makes it easy to use many of the functions of the System from a distance of up to 7 m away. The remote sensor at which you need to point the Remote Control differs depending on whether the Unit is placed vertically or horizontally.

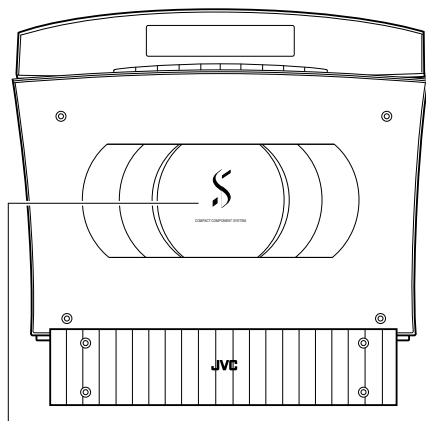

Remote sensor (when the Unit is placed vertically)

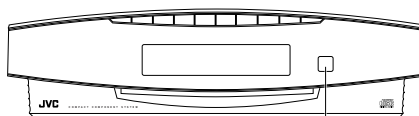

Remote sensor (when the Unit is placed horizontally)
 • The maximum operating distance becomes short when the Panel is opened.



- Make sure that the "DISP.SET" switch on the rear of the Unit is set correctly.

COMPU Play

JVC's COMPU PLAY feature lets you control the most frequently used System functions with a single touch. With One Touch Operation you can play a CD, turn on the radio, or listen to an external equipment with a single press of the play button for that function. One Touch Operation turns the power on for you, then starts the function you have specified. If the System is not ready (no CD in place), the System still powers on so you can insert a CD. How One Touch Operation works in each case is explained in the section dealing with that function. The COMPU PLAY buttons are:

On the Remote Control

CD SELECT ►/|| button
 FM/AM button
 MD/AUX button

On the Unit

SELECT ►/|| button
 SOURCE button

- The indicators for the buttons are invisible in Standby mode.
 Check the position of the buttons while the System is turned on.

Basic Operations

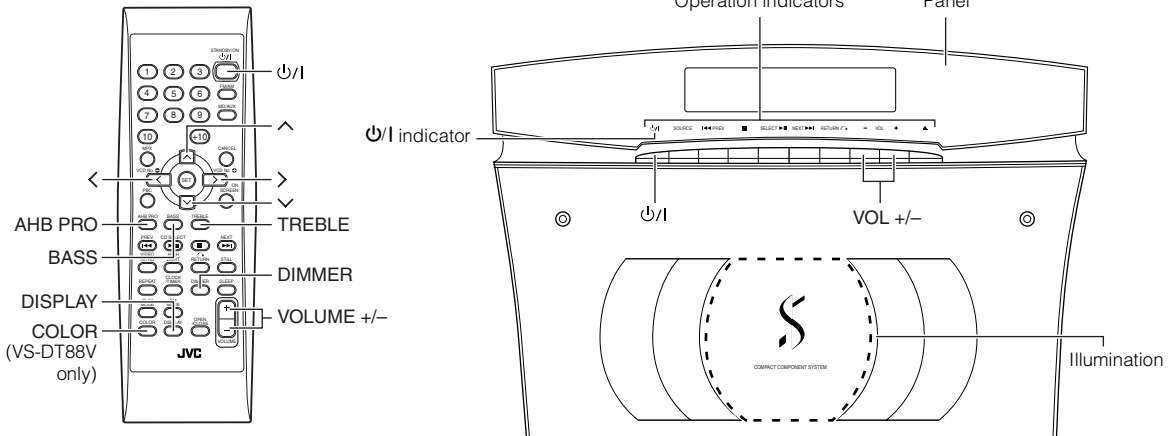

Turning the Power On and Off

Turning the System On

Press the P/I button.

The display comes on and “HELLO” appears once. The operation indicators appear on the Panel. (The Panel opens automatically if the Unit is placed vertically and the DISP.SET switch on the rear of the Unit is set to “V”.)

The System comes on ready to continue in the mode it was in when the power was last turned off.

■ For example, if the last thing you were doing was listening to a CD, you are now ready to listen to a CD again. If you wish, you can change to another source.

■ If you were listening to the Tuner last, the Tuner comes on playing the station it was last set to.

Turning the System Off

Press the P/I button again.

The Panel closes if it has been opened. “GOOD BYE” appears and the display goes out, except for the clock display. The P/I indicator (red) remains lit and the rest of the operation indicators go out.

■ Some power is always consumed even though power is turned off (called Standby mode).

■ To switch off the System completely, unplug the AC power cord from the wall outlet. When you unplug the AC power cord, the clock will be reset to 0:00 after about 20 minutes.

Power Save Mode

You can reduce the power consumption in Standby mode.

Press the DISPLAY button on the Remote Control when the System is turned off.

- The clock display goes out.

CD-in indicator

While a disc is loaded in the Unit, the CD-in indicator appears on the display.

- The CD-in indicator appears while using the Tuner or external equipment and does not appear during CD operations.

Adjusting the Brightness (DIMMER)

(Using the Remote Control)

You can adjust the brightness of the backlighting for the display and the illumination on the cover.

When the System is Turned On

Each time you press the DIMMER button, the brightness of the backlighting and the illumination on the cover change as follows:



Display	Backlighting	Illumination
DIMMER OFF	Bright	Bright
DIMMER 1	Slightly Dark	Slightly Dark
DIMMER 2	Dark	Off

Note

- When the System is turned off once, then turned on again, the brightness setting will be restored to the previous one since the setting is stored in memory.

Basic Operations

Changing the Color (COLOR) (VS-DT88V only)

(Using the Remote Control)

You can change the color of the illumination on the Unit.

- 1** Press the \odot /I button to turn on the System.
- 2** Press the COLOR button.
"RANDOM COLOR" appears.
- 3** Press the \wedge or \vee button to select the setting of your choice.

The color changes as follows:

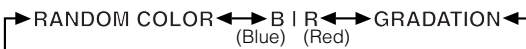

- RANDOM COLOR:** The color changes randomly.
- B | R:** The color between blue and red is selectable in 16 steps using the > or < button.
- GRADATION:** The color changes gradually between blue and red.

Adjusting the Volume

To increase the volume, press the VOLUME + button on the Remote Control (or the VOL + button on the Unit). To decrease the volume, press the VOLUME – button on the Remote Control (or the VOL – button on the Unit).

VOLUME 15

You can adjust the volume level between 0 and 50.

CAUTION:

- **DO NOT** turn off the System with the volume set to an extremely high level; otherwise a sudden blast of sound could damage your hearing, speakers and/or headphones when you turn on the System or start playing any source next time.
REMEMBER you cannot adjust the volume level while the System is in Standby mode.

For private listening

Connect a pair of headphones to the PHONES jack. No sound comes out of the speakers. Be sure to decrease the volume before connecting or putting on headphones.

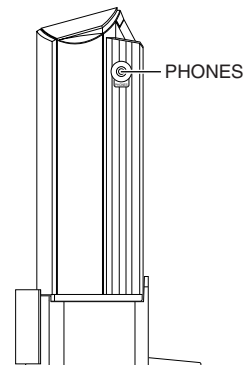

Reinforcing the Bass Sound (AHB PRO)

(Using the Remote Control)

You can reinforce the bass sound to maintain rich, full bass at low volume.

To get the effect, press the AHB (Active Hyper Bass) PRO button.

The “AHB PRO” indicator appears on the display.

To cancel the effect, press the button again.

The “AHB PRO” indicator goes out.

Tone Control (BASS/TREBLE)

(Using the Remote Control)

You can control the tone by changing the bass and treble.

BASS Control

You can adjust the bass level (low frequency range level) between -5 and +5. (0: Flat)

1 Press the BASS button.

BASS +5

2 Press the \wedge or \vee button to adjust the bass level.

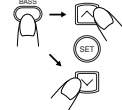

TREBLE Control

You can adjust the treble level (high frequency range level) between -5 and +5. (0: Flat)

1 Press the TREBLE button.

TREBLE +5

2 Press the \wedge or \vee button to adjust the treble level.

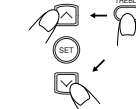

TREBLE -5

Note

- Press the \wedge or \vee button within 5 seconds to adjust the level after pressing the BASS or TREBLE button.

Showing the Time (DISPLAY)

(Using the Remote Control)

You can show the current time on the display.

To display the clock, press the DISPLAY button.

To return to the previous mode, press the same button again.

7:00

Note

- To let the clock work, you need to set the clock first. (See “Setting the Clock” on page 27.)

Using the Tuner

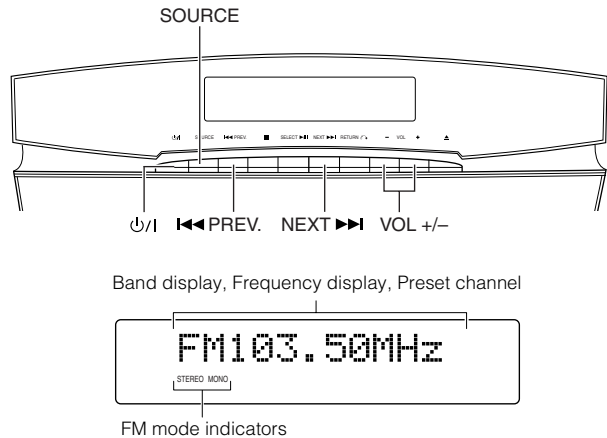
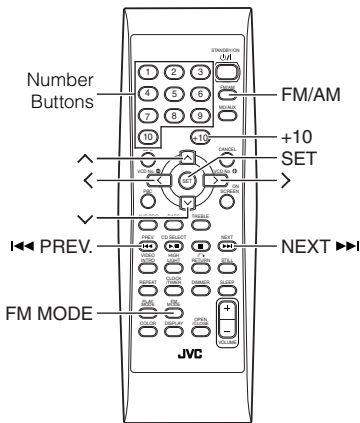

* When the System is in use, the display shows other items as well.
For simplicity, we show here only the items described in this section.

You can listen to FM and AM stations. Stations can be tuned in manually, automatically, or from preset memory storage.

■ Before listening to the radio:

- Make sure that both the FM and AM antennas are correctly connected. (See page 4 and 5.)

Setting the AM Tuner Interval Spacing

When shipped, the AM tuner interval is set to 10 kHz spacing.

You can change it to 9 kHz spacing.

■ Before proceeding:

1. Tune in AM stations to check the AM tuner interval (10 kHz or 9 kHz spacing).
2. Check the positions of the VOL +/- and P/I buttons on the Unit.
3. **Turn off the System.**

To select 9 kHz intervals, while holding down the VOL - button on the Unit, press the P/I button on the Unit. The Unit turns on and "AM 531kHz" will appear on the display.

To select 10 kHz intervals, while holding down the VOL + button on the Unit, press the P/I button on the Unit. The Unit turns on and "AM 530kHz" will appear on the display (at the same time, the 100 kHz spacing is selected for FM broadcast).

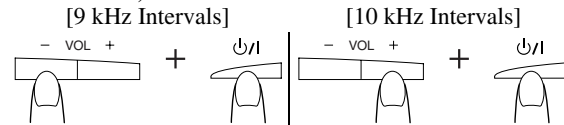

Note

- When you change the setting, the preset stations are erased. You will need to preset the stations again. (See page 16.)

One Touch Radio

Press the FM/AM button on the Remote Control to turn on the System and start playing the station you were last tuned to.

- You can switch from any other sound source to the radio by pressing the FM/AM button on the Remote Control (or the SOURCE button on the Unit).

Tuning In a Station

1 Press the FM/AM button.

The Band and Frequency you were last tuned to appear on the display.

(If the last station was selected using the preset number, the preset number appears first.)

Each time you press the button, the band alternates between FM and AM.

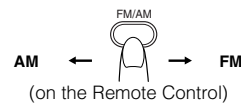

● Using the SOURCE button on the Unit

Each time you press the button, the sound source changes.

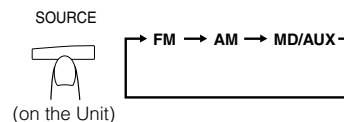

2 Select a station using one of the following methods.

● Manual Tuning

Press the P/I PREV. or NEXT P/I (\wedge or \vee) button repeatedly to move from frequency to frequency until you find the station you want.

OR

● Auto Tuning

If you press and hold the ◀◀ PREV. or NEXT ▶▶ (∧ or ∨) button for one second or more, the frequency changes down, or up, automatically until a station is found.

OR

● Preset Tuning using the Remote Control (Possible only after presetting stations)

Select the desired preset number using the Number buttons on the Remote Control. (For the preset number more than 10, press the +10 button then the Number button.) After 1 second the display will show the preset number's band and frequency.

Example:

Press the +10 button then the 2 button continuously. The preset number 12 "P12" appears.

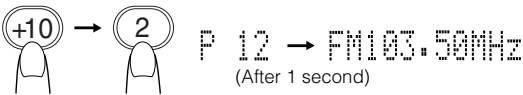
**Note**

- In AM broadcast, reception sensitivity will be changed by turning the AM loop antenna. Turn the AM loop antenna for best reception.

Presetting Stations**(Using the Remote Control)**

You can preset up to 30 FM stations and up to 15 AM stations.

Note

- Preset numbers may have been set to factory test frequencies prior to shipment. This is not a malfunction. You can preset the stations you want into memory by following one of the presetting methods below.

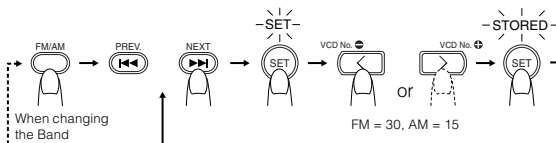
Manual Presetting

1 Select a band by pressing the FM/AM button.

2 Press the ◀◀ PREV. or NEXT ▶▶ (∧ or ∨) button to tune in a station.

3 Press the SET button.

“SET” will blink for 5 seconds.

Within 5 seconds, proceed to the next step.

When “SET” stops blinking and disappears after 5 seconds, press the SET button again.

4 Press the > or < button within 5 seconds to select the preset number.

> or < button: Increase or decrease the preset number by 1.

Pressing and holding the button will rapidly increase or decrease the preset number.

5 Press the SET button within 5 seconds.

“STORED” appears and after 2 seconds, the display returns to the broadcast frequency display.

6 Repeat above steps 1 to 5 for each station you want to store in memory with a preset number.

To change the preset stations, repeat the same steps as above.

CAUTION:

- Even if the system is unplugged or if the power failure occurs, the preset stations will be stored for about 24 hours. However, in case the preset stations are erased, you will need to preset the stations again.

To Change the FM Reception Mode**(Using the Remote Control)**

When you are tuned into an FM stereo broadcast, the “STEREO” indicator appears and you can hear stereo effects.

If an FM stereo broadcast is hard to receive or noisy, you can select Monaural mode. Reception improves, but you lose stereo effect.

Press the FM MODE button so that the “MONO” indicator appears on the display.

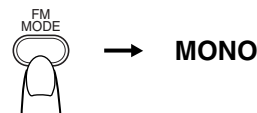

To restore the stereo effect, press the FM MODE button so that the “MONO” indicator goes out.

Using the CD Player

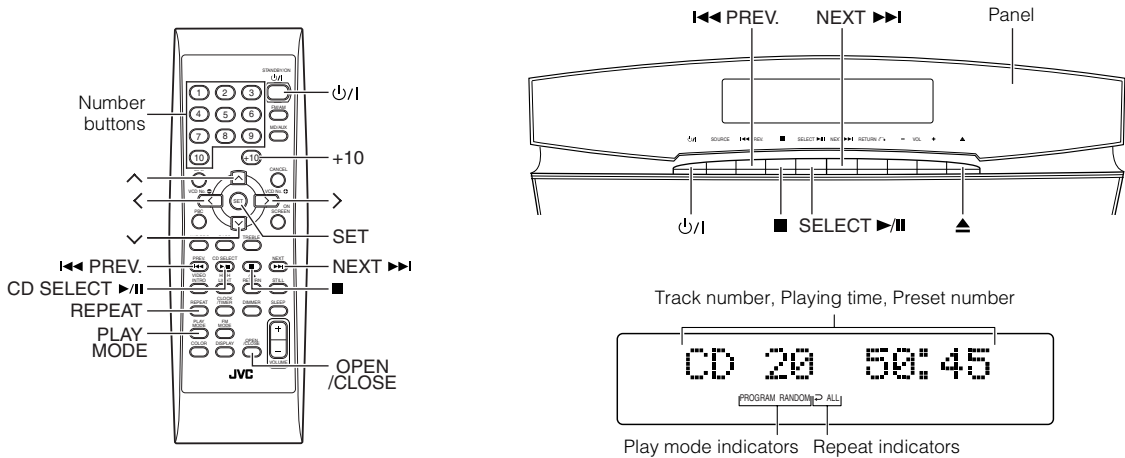

* When the System is in use, the display shows other items as well.
For simplicity, we show here only the items described in this section.

You can use Normal, Random, Program or Repeat play. Repeat Play can repeat all the tracks or just one of the tracks on the CD.

Here are the basic things you need to know to play a CD and locate the different tracks on it.

This unit has been designed to play back the following CDs:

- CD
- CD-R
- CD-RW
- MP3 discs (MP3 files recorded on a CD-R or CD-RW)

When playing a CD-R or CD-RW

You can play back **finalized CD-R** or **CD-RW** recorded in Music CD format or recorded in MP3 format.

- You can play back CD-R or CD-RW like CD.
- Some CD-R or CD-RW may not be played back on this unit because of their disc characteristics, damage or stain on them, or if the player lens is dirty.
- The reflection factor of CD-RW is lower than that of other CD, possibly causing CD-RW to take longer to read.
- When both audio CD format tracks and MP3 files are recorded on a CD-R or CD-RW, this unit plays back only one of them which is recognised first.

MP3 Introduction

What is MP3?

MP3 is an abbreviation of Motion Picture Experts Group 1 (or MPEG-1) Audio Layer 3. MP3 is simply a file format with a data compression ratio of 1:10 (128 kbps*). By using MP3 format, one CD-R or CD-RW can contain 10 times as much data volume as a regular CD can.

* Bit rate is the average number of bits that one second of audio data will consume. The unit used is kbps (1,000 bits per second). To get a better audio quality, choose a higher bit rate. The most popular bit rate for encoding (recording) is 128 kbps.

MP3 disc structure

On an MP3 disc, each song (material) is recorded as a file. Files are grouped into a directory (or folder). Directories can also include other directories, creating hierarchical directory layers. (See "How are MP3 files recorded and played back?" on page 18.)

This unit manages files and directories as "tracks" and "groups". This unit can recognise up to 255 tracks and up to 64 groups per disc. The unit ignores those exceeding the maximum numbers and cannot play them back.

Notes

- MP3 discs (either CD-R or CD-RW) require a longer readout time. (It differs due to the complexity of the group/file configuration.)
- When making an MP3 disc, select ISO 9660 Level 1 or Level 2 as the disc format.
- This unit does not support multisession recording.
- This unit can play MP3 files only with the following file extensions — ".MP3", ".Mp3", ".mP3", and ".mp3".
- Files other than MP3 are ignored.
- Some MP3 discs may not be played back because of their disc characteristics or recording conditions.

How are MP3 files recorded and played back?

MP3 “tracks (files)” can be recorded in “groups” — folders or directories, in PC terminology.

During recording, the tracks and groups can be arranged similarly to the tracks and folders/directories of computer data. “Root” is similar to the root of a tree. Every track and group can be linked to the root.

In compliance with ISO 9660, the maximum allowable depth of nested directories — so called “hierarchy” — is eight (inclusive of the root).

Playback order, track search order, and group search order of the MP3 tracks recorded on a disc are determined by the writing (or encoding) application; therefore, playback order may be different from the one you have intended while recording the groups and the tracks.

The illustration shows an ordinary example of how MP3 tracks are recorded on a CD-R or CD-RW, how they are played back and how they are searched for on this unit.

- The numbers in circles next to the MP3 tracks (♪) indicate the playback order and search order of the MP3 tracks. Normally this unit plays back MP3 tracks in the recorded order.
 - The numbers inside the groups indicate the playback order and search order of the groups on an MP3 disc. Normally this unit plays back MP3 tracks in the groups in the recorded order.
- The groups marked with asterisk (*) will be skipped since they do not include any MP3 tracks.

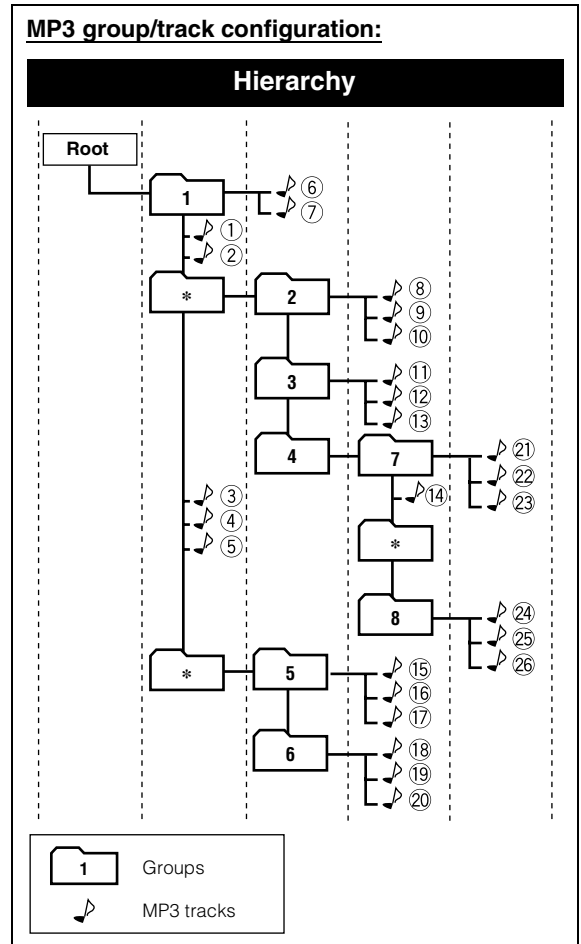

Using the CD Player

The Quickest Way to Start a CD is with the One Touch Operation

- Press the CD SELECT ►/|| button on the Remote Control.
 - The power is automatically turned on. If a CD is already inserted, it will start playing from the first track.
 - If no CD is inserted, "CD NO DISC" appears on the display and the CD Player remains in Stop mode.

To Insert a CD

1 Press the ⏻/| button.

(When the Unit is placed vertically)

The Panel opens automatically.

(When the Unit is placed horizontally)

To open the Panel, press the ▲ button on the Unit or the OPEN/CLOSE button on the Remote Control.

2 Insert a CD into the loading slot, with its label side front or up as shown below.

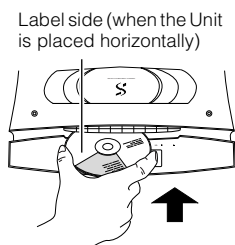
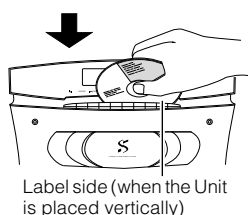

- An 8 cm CD cannot be played back in this Unit. (Do not attempt to insert an 8 cm CD using an adapter. Doing so will damage the Unit.)
- If the CD cannot be read correctly (because it is scratched or loaded upside down, for example), "CANNOT PLAY" appears on the display.
- You can insert a CD while listening to the other source.

⚠ CAUTIONS:

- DO NOT try to open or close the Panel by hands as it will be damaged. Press the OPEN/CLOSE button on the Remote Control to open or close the Panel.
- DO NOT try to insert another CD when a CD has been already loaded in the Unit. Doing so will damage the CDs and the Unit.
- DO NOT apply any shock to the Panel when it is open.
- DO NOT clean the Panel when it is open.

To Unload a CD

(Using the Unit)

Press the ▲ button to unload a CD. The CD is unloaded automatically, then take out the CD.

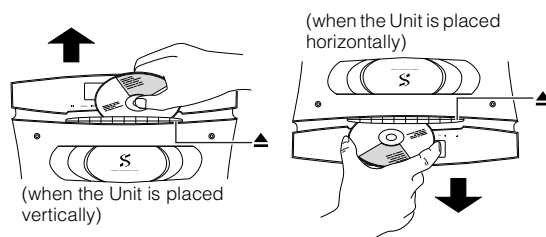

Basics of Using the CD Player — Normal Play

To Play Audio CDs or Video CDs

- The display explained here is for digital audio CDs. When a video CD is played, "VCD" will appear instead of "CD".

1 Insert a CD.

2 Press the CD SELECT ►/|| button on the Remote Control (or the SELECT ►/|| button on the Unit).

The first track of the CD begins playing.

CD 1 0:05
 Track number Playback time

- The CD Player automatically stops when the last track of the CD has finished playing.

To stop playing the CD, press the ■ button. The following information for the CD appears.

CD 18 50:45
 Total track number Total playback time

To stop playing and remove the CD, press the ▲ button on the Unit.

To pause, press the CD SELECT ►/|| button on the Remote Control or the SELECT ►/|| button on the Unit. The playback time blinks on the display.

To cancel pause, press the same button again. Play continues from the point where it was paused.

To Play MP3 Discs

1 Insert a disc.

The Unit searches for the disc (it may take time), and the following information appears on the display.

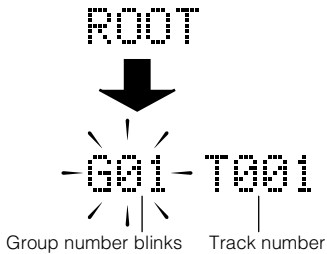

2 Select a track to start playing with.

1. Press the NEXT ►►| or |◄◄ PREV. button to select the group you want, then press the CD SELECT ►/|| button on the Remote Control (or the SELECT ►/|| button on the Unit). The track number starts blinking.
2. Press the NEXT ►►| or |◄◄ PREV. button to select the track you want to start playback with, then press the CD SELECT ►/|| button on the Remote Control (or the SELECT ►/|| button on the Unit) again.

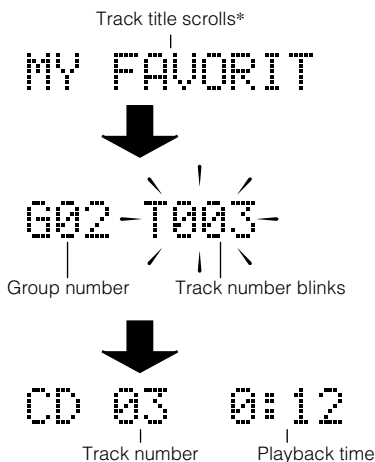

* Only a maximum of 10 characters (including spaces between words) can be shown on the display. The exceeding characters will be ignored.

Playback starts with the selected track of the selected group.

To stop playing and remove the CD, press the ▲ button on the Unit.

To pause, press the CD SELECT ►/|| button on the Remote Control or the SELECT ►/|| button on the Unit. The playback time blinks on the display.

To cancel pause, press the same button again. Play continues from the point where it was paused.

To Select a Track or Passage within a Track

In the stop mode or during playback, press the Number button on the Remote Control to select the track you want.

- The selected track starts playing.
- For the track number more than 10, press the +10 button then the Number button.

OR

During playback, press the NEXT ►►| or |◄◄ PREV. button to select the track you want.

- The selected track starts playing.
- Press the NEXT ►►| button once to skip to the beginning of the next track.
- **(For Audio CDs and Video CDs)**
Press the |◄◄ PREV. button to skip to the beginning of the track being played. Press twice quickly to skip to the beginning of the previous track.
- **(For MP3 Discs)**
Press the |◄◄ PREV. button to skip to the beginning of the previous track.

Search Play

Holding down the NEXT ►►| or |◄◄ PREV. button, during playback, will fast forward/backward the CD so you can quickly find a particular passage in the track you are listening to.

Note

- The < or > and ^ or v buttons on the Remote Control operate the same as the NEXT ►►| or |◄◄ PREV. button does.

Programming the Playing Order of the Tracks

(Using the Remote Control)

You can program the playing order of the tracks.

- You can program up to 50 tracks in any desired order including the same tracks.
- You can only make a program when the CD Player is stopped.

1 Insert a CD.

2 Press the CD SELECT ►/|| button.

3 Press the ■ button to stop the CD.

4 Press the PLAY MODE button until the "PROGRAM" indicator appears.

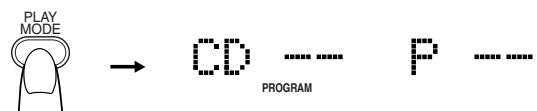

(To be continued on the next page)

Using the CD Player

5 Press the Number button to select the track to program.

Each time you press the Number button, the selected track is added to the program.

- For the track number more than 10, press the +10 button then the Number button.

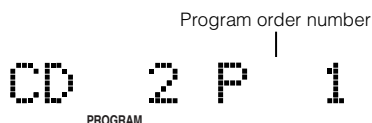

6 Repeat step 5 to select the other tracks for the program.

7 Press the CD SELECT ►/|| button.

The System plays the tracks in the order you have programmed them.

- Press the NEXT ►►| button once to skip to the beginning of the next track in the program.

■ (For Audio CDs and Video CDs)

Press the ◀◀ PREV. button to skip to the beginning of the track being played. Press twice quickly to skip to the beginning of the previous track in the program.

(For MP3 Discs)

Press the ◀◀ PREV. button to skip to the beginning of the previous track in the program.

- To stop playing, press the ■ button once.

To confirm the programmed tracks, while the CD player is stopped, each time press the NEXT ►►| or ◀◀ PREV. button; the tracks making up the program will successively appear in the programmed order.

To exit the program mode once, while the CD Player is stopped, press the PLAY MODE button (or the ■ button twice) to turn off the “PROGRAM” indicator and carry out Normal Play.

To Modify the Program

Modify the contents of the program while the CD Player is stopped.

Each time you press the CANCEL button, the last track in the program is deleted. To add new tracks to the end of the program, repeat above step 5.

- To delete all the tracks in the program, press the ■ button.

Random Play

(Using the Remote Control)

The tracks will play in random order when you use this mode.

- To enter Random Play mode, stop playback first.

1 Press the PLAY MODE button until the “RANDOM” indicator appears.

2 Press the CD SELECT ►/|| button.

The tracks are played in random order.

To skip a track during playback, press the NEXT ►►| button to jump to the next track in the random sequence.

To exit Random Play mode, while the CD Player is stopped, press the PLAY MODE button (or the ■ button) to turn off the “RANDOM” indicator and carry out Normal Play.

Repeating Tracks

(Using the Remote Control)

You can repeat all tracks or individual track, as many times as you like.

Press the REPEAT button.

The Repeat indicator changes with each press of the button, as shown below.

◁→▷ ALL→blank display → (back to the beginning)

▷ : Repeats one track.

▷ ALL: In Normal Play mode, repeats all the tracks. In Program Play mode, repeats all the tracks in the program.

In Random Play mode, repeats all the tracks in random order.

To exit Repeat mode, press the REPEAT button until the Repeat indicator on the display goes out.

Child Lock

(Using the Unit)

You can prevent the unwanted CD ejection by locking.

- Before proceeding, check the position of the NEXT ►►| button, then **turn off the System**.

To Lock the CD Ejection

While holding down the NEXT ►►| button, press the ◻/| button.

“LOCKED” appears on the display.

To Release the Lock

Perform the same procedure when you locked.

“UNLOCKED” appears on the display.

Using the Video CD Player (Video CDs)

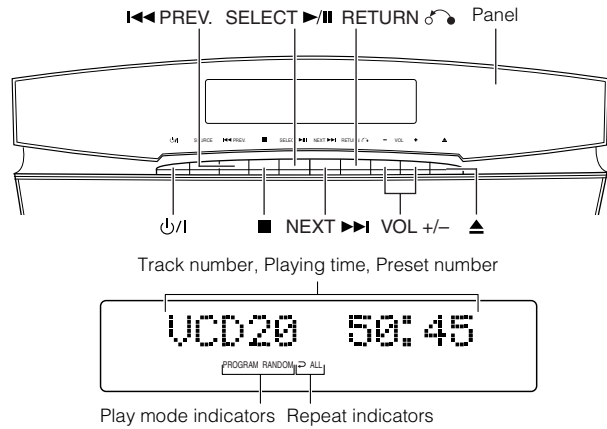
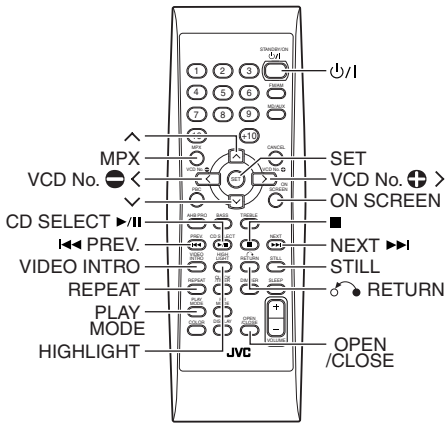

* When the System is in use, the display shows other items as well.
For simplicity, we show here only the items described in this section.

You can play video CDs (with or without the Playback Control (PBC) function) to watch the picture on your TV while listening to the sound on video CDs. SVCDs, DVDs, CD-G, CD-I or CD-ROM Discs cannot be used.

- Before playing video CDs
 - Make sure that the connection between the System and your TV is correct. (See page 7.)

Setting the TV System

(Using the Remote Control)

To view a picture of video CDs, it is required to set the System's TV system according to your TV system.

Relationship among the playable CDs, System's TV system and your TV system:

Playable CD	System's TV system	Your TV system
NTSC/PAL	NTSC	NTSC
NTSC/PAL	PAL	PAL
NTSC/PAL	PAL AUTO	Multisystem

1 Turn off the System.

2 Press and hold the ■ button.

The current TV system ("PAL" for example) appears on the display for 5 seconds.

3 Within 5 seconds, press the NEXT ►► (or ◀◀ PREV.) button to select the TV system.

Each time you press the button, the TV system changes as follows:



4 Within 5 seconds, press the ■ button.

Notes

- If you play a video CD of NTSC system in PAL AUTO system on a PAL exclusive TV, the image may be distorted. If this happens, change to "PAL".
- When you play a video CD of NTSC system in PAL AUTO system on a multisystem TV, the image may blink for a moment. This symptom occurs when the System detects the formula of the video CD and is not a malfunction.

Selecting the Audio Channel

This function may be used for CDs that support multiplex function. In addition to the normal stereo sound output, you can select L channel or R channel independently.

Press the MPX button on the Remote Control.

Each time you press the button, the selected channel changes as follows:



Using the Video CD Player (Video CDs)

Playing Video CDs with PBC Function

(Using the Remote Control)

The System provides a Playback Control (PBC) function which utilizes a procedure (menu selection) programmed in a video CD.

What is the Playback Control (PBC) function?

The PBC function allows you to enjoy the following features:

- **Menu-Driven Play**
You can interact with the TV screen using a menu display to select and play an entry.
- **High-resolution still image display**
You can display high-quality images four times clearer than video pictures.
- For operation, refer to the instructions supplied for the video CD.
- You can play video CDs with PBC function using the menu screen (Menu-Driven Play) or without using the menu screen (Normal Play).

Notes

- The playback operation procedure may differ depending on the video CD you use.
- Sometimes due to improper manufacturing, video CDs will function differently.

Playing Video CDs with the PBC Function Using the Menu Screen (Menu-Driven Play)

- Before playing, make sure that Repeat indicator “↻” or “↻ ALL” is not appearing. If appearing, press the REPEAT button on the Remote Control until it goes out.
- Also, make sure that the “PROGRAM” or “RANDOM” indicator is not appearing. If appearing, press the PLAY MODE button on the Remote Control until it goes out.

1 Insert a video CD with the PBC function.

In stop mode, press the PBC button until “PBC ON” appears on the display.

Each time you press the button, the display alternates as follows:

PBC ON ↔ PBC OFF

2 Press the CD SELECT ►/|| button.

“PBC” appears on the display and the first menu will appear on the TV screen.

3 To move through the next menu, press the NEXT ►▶| or |◀◀ PREV. button.

4 Press the Number button to select the item (track) in the menu.

- The next menu appears or the playback of the selected track starts.
- Pressing ⏪ RETURN returns to the previous menu.
- The next track will be automatically played after the current track is finished.
- While a part of movie is displayed on the TV in step 2, pressing the CD SELECT ►/|| button causes the track being played to play from the beginning.

To pause, press the CD SELECT ►/|| button.

To resume pause, press the CD SELECT ►/|| button.

To stop playback, press the ■ button.

To select other item during playback, repeat step 4.

Notes

- Program Play, Random Play and Repeating Tracks cannot be made in this Menu-Driven Play.
- When the power is turned off, the disc is changed, or a source other than CD is set (e.g. Tuner, AUX), the PBC ON mode changes back to PBC OFF.
- Some video CDs with the PBC function may not automatically play the next track after the current track is finished. This depends on the PBC program writing.

Basic Remote Control Button Functions for Menu-Driven Play:

Remote Control	Function
◀◀ PREV. / NEXT ▶▶	Move through menu.
1 – 10, +10	Select a specific menu item.
CD SELECT ►/	Enters the selected video CD number or item. When a part of movie is displayed on the TV screen, starts playing that track from the beginning.
⏪ RETURN	Returns to the previous menu during playback.

Note

- The buttons on the Unit operate the same as the buttons on the Remote Control do.

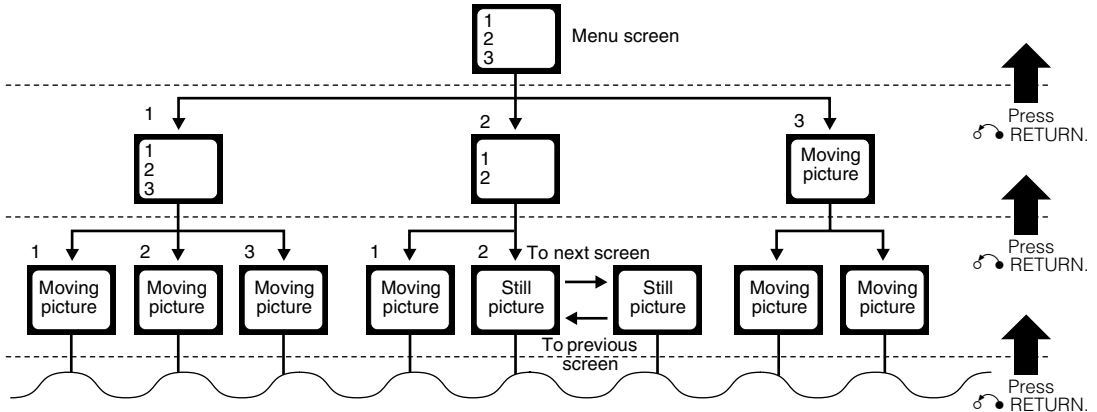

A selection menu appears when you start playing a video CD with the PBC function. The selection menu shows a list of numbers for selection. Some video CDs may show moving pictures or a divided screen.

- When a list of numbers is displayed, selecting a number shows its contents.
- When a moving picture is displayed, pressing the CD SELECT ►/|| at the time when a part of the movie you desire is shown plays the movie.
- When the selection menu re-appears after you have played your selection, selecting a number again can replay its contents. (Some video CDs may show the menu screen several times.)
- When “NEXT” and “PREV.” appear, pressing NEXT ►► or ◀◀ PREV. can change the selection menu.
- After playback, press ⏪ RETURN to go back to the previous screen. Some video CDs may return you to the menu screen shown before playback.



- When using the REPEAT function, the PBC function is not available.

Playing Video CDs with PBC Function without Using the Menu Screen (PBC OFF)

(Using the Remote Control)

You can play video CDs with the PBC function without using the menu screen, as if they were without the PBC function.

- 1 Insert a video CD with the PBC function.
- 2 In stop mode, press the PBC button until “PBC OFF” appears on the display.

Each time you press the button, the display alternates as follows:

PBC OFF ↔ PBC ON

For Program Play, Random Play, Repeating Tracks:

Select the mode by pressing respective buttons in the same way as for audio CDs. (See pages 20 – 21.)

- 3 Press the CD SELECT ►/|| button to play the video CD.

Playing Video CDs without the PBC Function

Basic playback procedures for video CDs are the same as for audio CDs. (See pages 17 – 21.)

- When you start playing a video CD without the PBC function, “VCD” appears on the display.



- During playback a Video CD, the following operations may distort the image on the TV screen: Searching for the beginning of the track, Skipping the tracks, or Pausing the tracks.

Using the Video CD Player (Video CDs)

Various Functions to Enhance Your Enjoyment

(Using the Remote Control)

You can use the following features.

Frame-by-Frame Playback

Frame-by-Frame Playback is possible only when moving pictures (of the video CDs with or without the PBC function) are played.

During playback, press the STILL button to pause the video CD and then press the STILL button again.

Each time you press the STILL button, the picture advances by one frame. During Frame-by-Frame Playback, no sound comes out.

To resume Normal Play, press the CD SELECT ►/|| button.

Display of Operating Status

You can view the current operating status on the TV screen.

Press the ON SCREEN button.

Each time you press the button, the track number and play-time are displayed on the TV screen.

Viewing the Video Intro of Video CDs

You can check the contents of a video CD.

1 Insert a video CD.

“PBC OFF” is displayed.

2 Press the VIDEO INTRO button.

The Video Intro Play starts and the first 7 seconds of nine tracks are played in sequence.

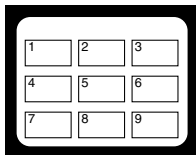

- To view the Video Intro after the ninth track, press the VCD No. ⏪ button. To return to the first nine tracks, press the VCD No. ⏩ button.

3 Press the Number button to select the track. Normal Play starts from the selected track.

- For the track number more than 10, press the +10 button then the Number button.

To stop and cancel the Video Intro Play, press the ■ button.



- During the Video Intro Play, image shown on the TV screen may be partially distorted, resulting from noises or incorrect manufacturing of the CD.

Viewing the Highlights of Video CDs

You can view nine highlight scenes of the selected track on a video CD. These highlight scenes are created by dividing the track equally into nine portions and the beginning (7 seconds each) of those nine scenes are shown on the TV screen.

1 Insert a video CD.

2 Press the HIGHLIGHT button.

The Highlight Play starts and shows in sequence, the first 7 seconds of nine divided highlight scenes on the TV screen for one minute.

TV screen will show the below:

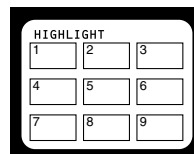

- To select the track, press the VCD No. ⏪ or ⏩ button.

3 Press the Number button to select the highlight number.

Playback starts from the selected scene.

To stop and cancel the Highlight Play, press the ■ button.



- Before the Highlight Play of a video CD with the PBC function, make sure that “PBC OFF” is displayed. (See “Playing Video CDs with PBC Function without Using the Menu Screen (PBC OFF)” on page 24.)
- When a highlight scene is selected, playback starts from the beginning of the highlight scene, but not from the still image shown on the TV screen (the part shown is the last part of the highlight scene, not its beginning).
- During the Highlight Play, image shown on the TV screen may be partially distorted, resulting from noises or incorrect manufacturing of the CD.
- Pressing the HIGHLIGHT button only starts the Highlight Play of the first track. To start the Highlight Play of another track, press the NEXT ►► button.

Using External Equipment

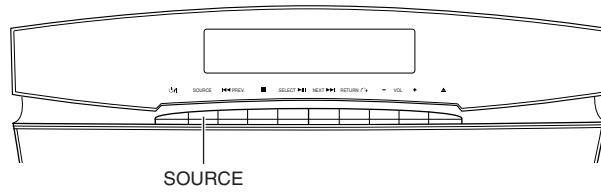
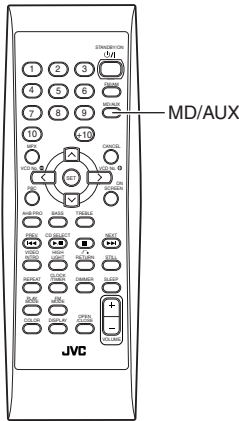

Listening to External Equipment

You can listen to external equipment such as MD recorder, tape deck or other auxiliary.

- First make sure that the external equipment is properly connected to the System. (See pages 7 and 8.)

1 Press the MD/AUX button.

“MD/AUX” appears on the display.

MD/AUX

- On the Unit, press the SOURCE button until “MD/AUX” appears on the display.

2 Start playing the external equipment.



- For operation of the external equipment, refer to its Instructions.

Recording the System's Source to External Equipment

You can record the System's source to external equipment which is connected to the MD/AUX-IN/OUT or CD DIGITAL OUT terminals of the System, such as MD recorder or tape deck, etc.

- First make sure that the external equipment is properly connected to the System. (See pages 7 and 8.)

Play the System's CD Player or tune in to a station.

- The recording level is not affected by the VOLUME level set by the System. Also it is not affected by the sound effects.



- For operation of the external equipment, refer to its Instructions.
- During playing a video CD or using the tuner, no signals come out from the CD DIGITAL OUT terminal.

Using the Timers

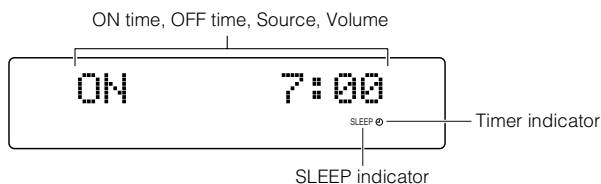
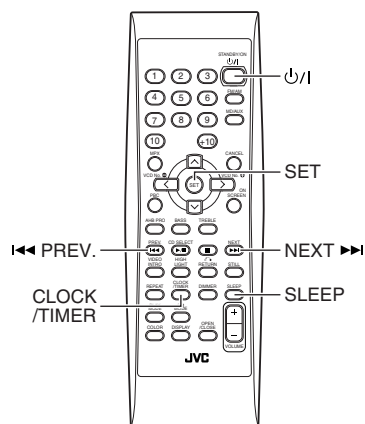

* When the System is in use, the display shows other items as well.
For simplicity, we show here only the items described in this section.

The timers let you control listening functions automatically.

Setting the Clock

(Using the Remote Control)

- When you plug the AC power cord into the wall outlet, the time indication "0:00" blinks on the display.



- The clock must be correctly set for the timers to work.

1 Press the ON/OFF button.

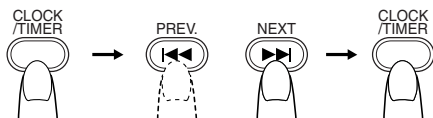

2 Press the CLOCK/TIMER button.

The hour digit of the time indication rapidly blinks on the display.

3 Press the NEXT >>> or <<< PREV. button to set the hour.

Pressing the NEXT >>> button moves the time forwards and pressing the <<< PREV. button moves it backwards. Press and hold the button to move the time rapidly.

4 Press the SET button.

The minute digits of the time indication rapidly blink on the display.

5 Press the NEXT >>> or <<< PREV. button to set the minute.

6 Press the SET button.

The selected time is set and the seconds start counting from 0.

CAUTION:

- If there is a power failure, the clock loses its setting after about 20 minutes. "0:00" blinks on the display and the clock must be reset.



- The clock may gain or lose one to two minutes per month.
- The ^ or v button operates the same as the <<< PREV. or NEXT >>> button does.

Setting the Daily Timer

(Using the Remote Control)

Once you have set the Daily Timer, the timer will be activated at the same time every day.

The Timer indicator (⊕) on the display shows that the Daily Timer you have set is in effect.

- When the Timer Indicator (⊕) is displayed, the timer is activated.
- When the Timer Indicator (⊕) is not displayed, the timer is deactivated.

1 Setting the ON time (Example: 10:15).

1. Press the CLOCK/TIMER button.
“TIMER” appears on the display.

TIMER

- When the clock is not set, “0:00” appears on the display. Set the clock first.
2. Press the CLOCK/TIMER button again. The hour digit of the “ON” time blinks on the display.

ON 

Press the ◀◀ PREV. or NEXT ▶▶ button to set the hour you want the Unit to be turned on.
Pressing the NEXT ▶▶ button moves the time forwards and pressing the ◀◀ PREV. button moves it backwards. Press and hold the button to move the time rapidly.

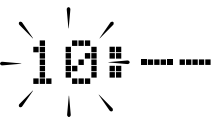
ON 

3. Press the SET button.
The minute digits of the ON time blink on the display.

ON 

Set the minute you want the Unit to be turned on, using the ◀◀ PREV. or NEXT ▶▶ button.

ON 

2 Setting the OFF time (Example: 13:30).

1. Press the SET button.
The hour digit of the OFF time blinks on the display. (The same time as the ON time will be automatically set.)

OFF 

Set the hour you want the Unit to be turned off, using the ◀◀ PREV. or NEXT ▶▶ button.

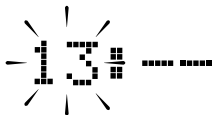
OFF 

2. Press the SET button.
The minute digits of the OFF time blink on the display.

OFF 

Set the minute you want the Unit to be turned off, using the ◀◀ PREV. or NEXT ▶▶ buttons.

OFF 

3 Selecting the music source.

1. Press the SET button.
The “TUNER” or “CD” blinks on the display.
2. Press the ◀◀ PREV. or NEXT ▶▶ button to select the music source you want to listen to.
The display changes as shown below:
TUNER ↔ CD ↔ (back to the beginning)

4 Setting the volume level.

1. Press the SET button.
The current volume setting blinks on the display.
2. Press the ◀◀ PREV. or NEXT ▶▶ button to select the volume level.
-- : The current volume level will be used.
0 to 50 : When the timer is turned on, the Volume will be automatically set to the selected level.

VOLUME 

5 Press the SET button.

The timer setting is completed and the Timer indicator (⊕) appears on the display. The display shows the each setting of the Timer and returns to the display before you set the Timer.

(To be continued on the next page)

Using the Timers

6 Before turning off the System, prepare the music source selected in step 3.

TUNER: Tune in to the desired station.

CD: Insert a CD. (Playback will start from the first track at Timer on.)

7 Press the **⏻** button to turn off the System.

In Standby mode, you can see the Timer indicator (**⏻**) on the display.

- When the timer turns on, the Timer indicator starts blinking and the prepared source in step 6 will be played.

To confirm the timer setting

Press the CLOCK/TIMER button, then press the SET button. Each setting appears on the display.

To cancel the timer

Press the CLOCK/TIMER button, then press the CANCEL button. The Timer indicator (**⏻**) goes out.

To re-activate the cancelled timer

Press the CLOCK/TIMER button, then press the SET button. The Timer indicator (**⏻**) appears.

To change the timer setting

Repeat the setting procedure from the beginning.

⚠ CAUTION:

- If the System is unplugged, or a power failure occurs, the timer setting will be lost. You will need to reset the clock first, then the timer.

Setting the Sleep Timer

(Using the Remote Control)

Use the Sleep Timer to turn the System off after a certain number of minutes when it is playing. By setting the Sleep Timer, you can fall asleep to music and know that your System will turn off by itself rather than play all night.

- You can only set the Sleep Timer when the System is on and a source is playing.

1 Play a CD or tune in to the desired station.

2 Press the SLEEP button.

The "SLEEP" indicator appears.

- When the clock is not set, "0:00" appears on the display. Set the clock at first.

3 Set the length of time you want the source to play before shutting off.

- Each time you press the SLEEP button, it changes the number of minutes shown on the display in this sequence:

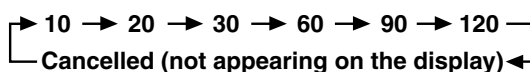

The selected number of minutes for the Sleep Timer will go out 5 seconds later and the display returns to the original one before setting the Sleep Timer. (The display is dimmed.)

The System is now set to turn off after the number of minutes you set.

To Confirm the Sleep Time

When the SLEEP button is pressed, the remaining sleep time appears. Wait until the display returns to the original display.

To Cancel the Sleep Timer Setting

Press the SLEEP button until the "SLEEP" indicator goes out on the display.

Turning off the System also cancels the Sleep Timer.

- If you are setting the Daily Timer, the System will be turned on at the set time to wake you up.

Care and Maintenance

Handle your CDs carefully, and they will last a long time.

Compact Discs



- Only CDs bearing these marks can be used with this System. However, continued use of irregular shape CDs (heart-shape, octagonal, etc.) can damage the System.
- Do not stick a paper tape or a seal on the reading side or the label side. If you do so, the CD may not be unloaded, or the System can be damaged.
- Remove the CD from its case by holding it at the edges while pressing the case's center hole lightly.
- Do not touch the shiny surface of the CD, or bend the CD.
- Put the CD back in its case after use to prevent warping.
- Be careful not to scratch the surface of the CD when placing it back in the case.
- Avoid exposure to direct sunlight, temperature extremes, and moisture.
- A dirty CD may not play correctly. If a CD does become dirty, wipe it with a soft cloth in a straight line from center to edge.

CAUTION:

- Do not use any solvent (for example, conventional record cleaner, spray thinner, benzine, etc.) to clean a CD.

Moisture Condensation

Moisture may condense on the lens inside the System in the following cases:

- After turning on heating in the room.
- In a damp room.
- If the System is brought directly from a cold to a warm place.

Should this occur, the System may malfunction. In this case, leave the System turned on for a few hours until the moisture evaporates, unplug the AC power cord, and then plug it in again.

General Notes

In general, you will have the best performance by keeping your CDs and the mechanism clean.

- Store CDs in their cases, and keep them in cabinets or on shelves.
- Keep the System's Panel closed when not in use.

Cleaning the Unit

- Stains on the Unit
Should be wiped off with a soft cloth. If the Unit is heavily stained, wipe it with a cloth soaked in water-diluted neutral detergent and wrung well, then wipe clean with a dry cloth.
- Since the Unit may deteriorate in quality, become damaged or get its paint peeled off, be careful about the followings.
 - DO NOT wipe it with a hard cloth.
 - DO NOT wipe it strong.
 - DO NOT wipe it with thinner or benzine.
 - DO NOT apply any volatile substance such as insecticides to it.
 - DO NOT allow any rubber or plastic to remain in contact with it for a long time.

Troubleshooting

- If you are having a problem with your System, check this list for a possible solution before calling for service.
- If you cannot solve the problem from the hints given here, or the System has been physically damaged, call a qualified person, such as your dealer, for service.

Symptom	Possible Cause	Action
No sound is heard.	<ul style="list-style-type: none"> • Connections are incorrect, or loose. • Headphones are connected. 	<ul style="list-style-type: none"> • Check all connections and make corrections. (See pages 3 to 8.) • Disconnect the headphones.
Poor radio reception.	<ul style="list-style-type: none"> • The antenna is disconnected. • The AM Loop Antenna is too close to the System. • The FM Wire Antenna is not properly extended and positioned. 	<ul style="list-style-type: none"> • Reconnect the antenna securely. • Change the position and direction of the AM Loop Antenna. • Extend FM Wire Antenna to the best reception position.
The CD skips.	The CD is dirty or scratched.	Clean or replace the CD.
The CD does not play.	<ul style="list-style-type: none"> • The CD is upside down. • No MP3 files are recorded on the disc. • MP3 files do not have the extension code —.MP3, .Mp3, .mP3, or .mp3. • MP3 files are not recorded in the format compliant with ISO 9660 Level 1 or Level 2. 	<ul style="list-style-type: none"> • Put the CD in with the label side up. • Replace the disc. • Check if all the files on the disc have the extension code —.MP3, .Mp3, .mP3, or .mp3. • Insert a CD-R or CD-RW that is recorded in MP3 format compliant with ISO 9660 Level 1 or Level 2.
The disc readout time is too long.	The readout time varies with the complexity of the recording configuration.	Do not use too many hierarchies and directories when recording. Also, do not record any other types of audio tracks together with MP3 files. (See page 18.)
Unable to operate the Remote Control.	<ul style="list-style-type: none"> • The path between the Remote Control and the sensor on the Unit is blocked. • The batteries have lost their charge. 	<ul style="list-style-type: none"> • Remove the obstruction. • Replace the batteries.
Noise is generated.	You are playing a compatible disc including non-MP3 files. While playing a non-MP3 file, you will hear a noise. (Note it may not be an MP3 file although it has the extension code —.MP3, .Mp3, .mP3, or .mp3.)	Insert a compatible disc that is not including non-MP3 files.
The image on the TV screen is distorted.	TV system is not matching.	Select the correct TV system. (See page 22.)
The picture of the video CD is distorted.	When you pause or skip the track, the pictures will be distorted.	This is not a malfunction.
Operations are disabled.	The built-in microprocessor has malfunctioned due to external electrical interference.	Unplug the System then plug it back in.
“CD NO DISC” appears.	There is no disc loaded.	Insert a disc.
“CANNOT PLAY” appears.	<ul style="list-style-type: none"> • The CD-R or CD-RW that hasn’t yet been finalized (including blank discs) has been inserted. • The disc has been inserted with its label side down. • An incompatible MP3 disc has been inserted. Some MP3 discs may not be played back because of their disc characteristics, damage or strains. 	<ul style="list-style-type: none"> • Insert a CD-R or CD-RW that has been finalized. • Remove the disc and insert it with the label side front or up. (See page 19.) • Insert a compatible MP3 disc.
The characters and symbols on the display appear upside down.	The DISP.SET switch on the rear panel of the Center Unit has not been set correctly.	Set the DISP.SET switch correctly. (See page 10.)

Specifications

Amplifier

Output Power	38 W (19 W + 19 W) at 4 Ω (Max.)
Input Sensitivity/Impedance (1 kHz)	
MD/AUX IN	500 mV/47 kΩ
Output Sensitivity/Impedance (1 kHz)	
MD/AUX OUT	500 mV/5 kΩ
CD DIGITAL OUT (Optical out)	-21 dBm - -15 dBm
Speaker terminals	4 Ω - 16 Ω
Subwoofer out	440 mV/6 kΩ
Phones	16 Ω - 1 kΩ
	0 - 15 mW/ch output into 32 Ω

CD Player

Signal-To-Noise Ratio	100 dB (typical)
Wow And Flutter	Unmeasurable
Playback Disc	Video CD (with/without Playback Control function), Audio CD
MP3 recording format	MPEG 1/2 Audio Layer 3
Max. Bit rate	320 kbps

Tuner

FM Tuning Range	87.50 MHz - 108.00 MHz
AM Tuning Range	
For Saudi Arabia	531 kHz - 1 602 kHz (at 9 kHz channel space) 530 kHz - 1 600 kHz (at 10 kHz channel space)
For other countries	531 kHz - 1 710 kHz (at 9 kHz channel space) 530 kHz - 1 710 kHz (at 10 kHz channel space)

Power Specifications

Power Requirements	AC 110/127/230 V ~ adjustable with the voltage selector, 50/60 Hz
Power Consumption	40 W (power on mode) 3.7 W (on standby with power save mode off) 2.3 W (on standby with power save mode on)

Center Unit

Dimensions*	(CA-VSDT88V/CA-VSDT68V)	325 mm × 86 mm × 237 mm (W/H/D)
Mass*	(CA-VSDT88V)	Approx. 4.0 kg
	(CA-VSDT68V)	Approx. 3.9 kg
* without Stand and Legs		

Speaker Specifications (each unit)

SP-VSDT88V	
Speakers	8 cm cone
Impedance	4 Ω
Dimensions	125 mm × 293 mm × 129 mm (W/H/D)
Mass	1.4 kg

SP-VSDT68V

Speakers	8 cm cone
Impedance	4 Ω
Dimensions	124 mm × 255 mm × 124 mm (W/H/D)
Mass	1.4 kg

Accessories

- Power Cord (1)
- AM Loop Antenna (1)
- Remote Control (1)
- Batteries R6P (SUM-3)/AA (15F) (2)
- FM Wire Antenna (1)
- Speaker Cords (2)
- Video Cord (1)
- Stand (1) (for Center Unit)
- Legs (2) (for Stand)
- Screw (1) (for Stand)
- Paper Pattern (1)
- AC Plug Adaptor (1)

Dimensions for Installation (CA-VSDT88V/CA-VSDT68V)

Vertical Position

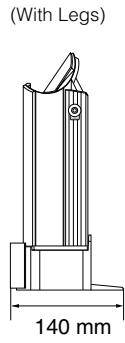
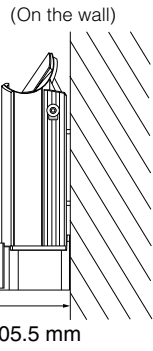
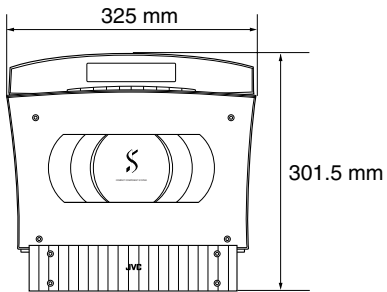

Horizontal Position

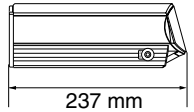
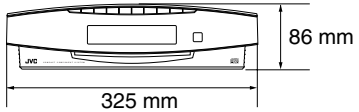

Design and specifications are subject to change without notice.

Mains (AC) Line Instruction (not applicable for Europe, U.S.A., Canada, Australia, and U.K.)

主(AC)电源线路说明(不适用于欧洲美国加拿大澳洲及英国型号)

CA-VSDT88V/CA-VSDT68V

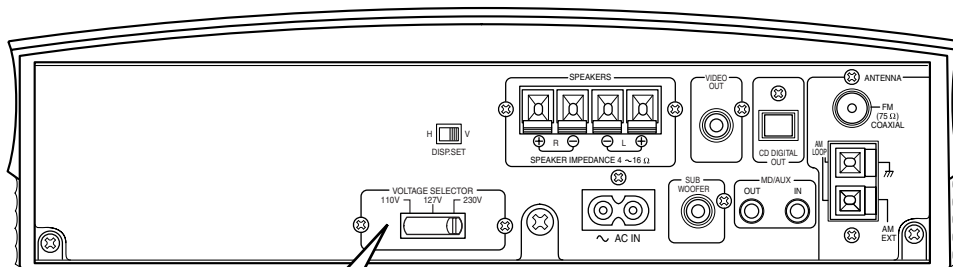

IMPORTANT for mains (AC) line

BEFORE PLUGGING IN, do check that your mains (AC) line voltage corresponds with the position of the voltage selector switch provided on the outside of this equipment and, if different, reset the voltage selector switch, to prevent from a damage or risk of fire/electric shock.

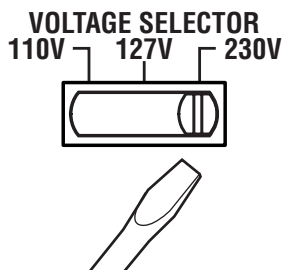

有关主(AC)电源线路的重要事项

接插电源以前, 务请检查当地的主(AC)电源线路电压是否位于本机外面的电压选择开关设定的位置一致。如果不一致, 即重新设定电压选择开关使其符合当地电压, 以免损坏机器或引起火灾/触电的危险。

JVC
VICTOR COMPANY OF JAPAN, LIMITED